

# FLOOR PLANS CAPACITY CHARTS

## THE WESTIN

KANSAS CITY  
AT CROWN CENTER



# MEETING SPACE OVERVIEW, PART ONE

1 East Pershing Road  
 Kansas City, Missouri 64108  
 T 816.474.4400 F 816.391.4438  
 E westincrowncenterkansascity@starwoodhotels.com  
 westincrowncenterkansascity.com

**THE WESTIN**  
 KANSAS CITY  
 AT CROWN CENTER

## TWENTIETH FLOOR

1. BENTON'S

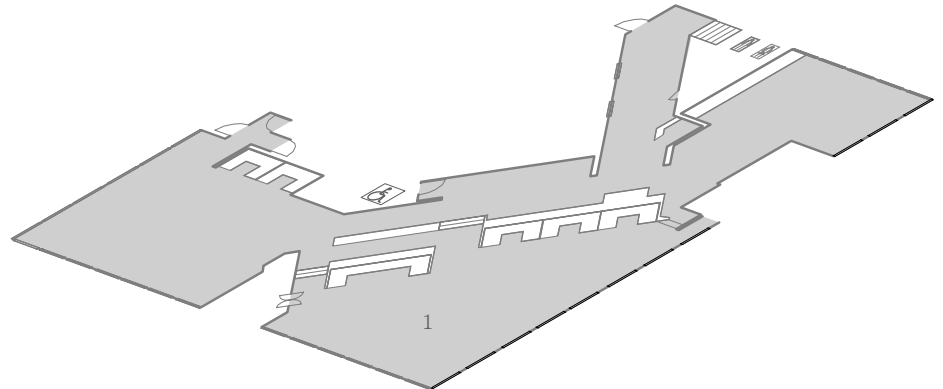

## FIFTH FLOOR

1. GOVERNORS
2. SENATORS
3. CONGRESSIONAL
4. AMBASSADORS
5. MAYORS
6. REGENTS

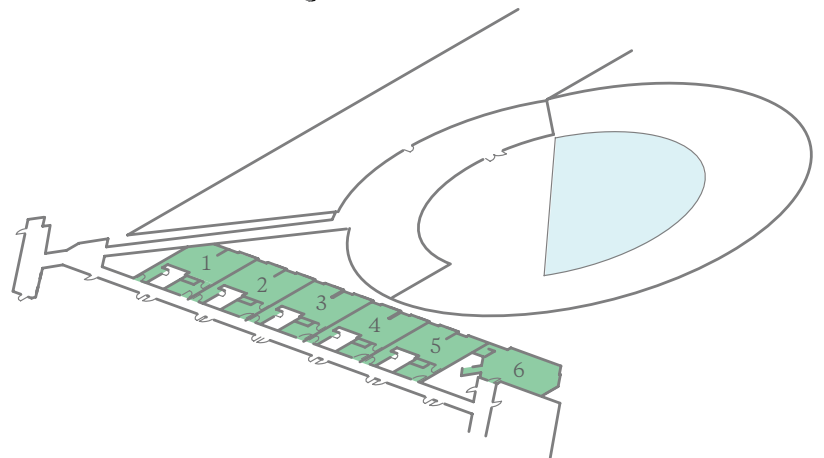

## BALLROOM LEVEL

1. CENTURY BALLROOM
2. WESTPORT
3. PENN VALLEY
4. ROANOKE
5. SHAWNEE
6. MISSION
7. LIBERTY
8. INDEPENDENCE
9. PRESIDENTS
10. PERSHING PLACE

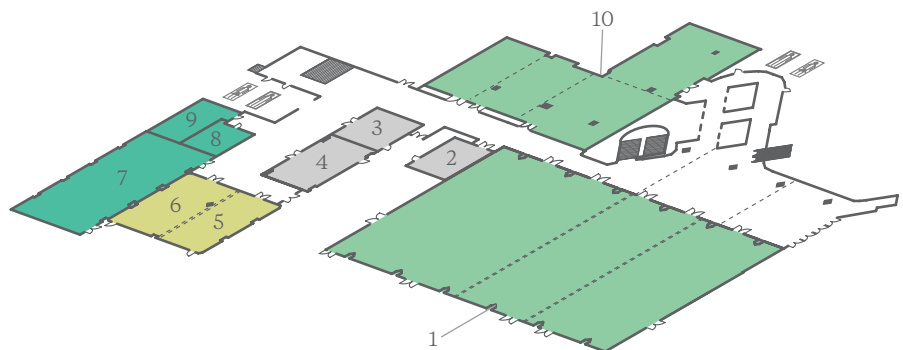

### ROOMS AT A GLANCE

TOTAL GUEST ROOMS	724
TOTAL MEETING ROOMS	32
LARGEST MEETING ROOM CAPACITY	2,000
LARGEST MEETING ROOM SIZE	1,495 m <sup>2</sup> / 15,590 ft <sup>2</sup>

Additional spaces for meetings and events, not displayed here, may also be available. Contact your hotel representative for more information.

This document contains approximate measurements and square footage that are for illustrative purposes only. We cannot guarantee the floor plan accuracy or completeness, therefore encourage you to review the space to make sure it is suitable for your event.

# MEETING SPACE OVERVIEW, PART TWO

1 East Pershing Road  
 Kansas City, Missouri 64108  
 T 816.474.4400 F 816.391.4438  
 E [westincrowncenterkansascity@starwoodhotels.com](mailto:westincrowncenterkansascity@starwoodhotels.com)  
[westincrowncenterkansascity.com](http://westincrowncenterkansascity.com)

**THE WESTIN**  
 KANSAS CITY  
 AT CROWN CENTER

## EXECUTIVE OFFICE LEVEL

1. GARDEN TERRACE
2. CROSSROADS
3. BOARDROOM

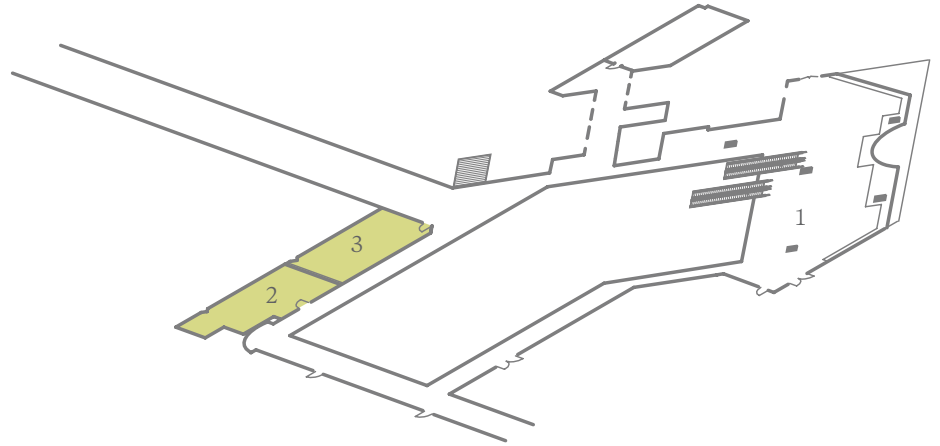

## LOBBY LEVEL

1. WASHINGTON PARK PLACE
2. WASHINGTON PARK FOYER
3. BROOKSIDE
4. UNION HILL
5. UNION HILL WEST
6. SIGNBOARD 1
7. SIGNBOARD 2

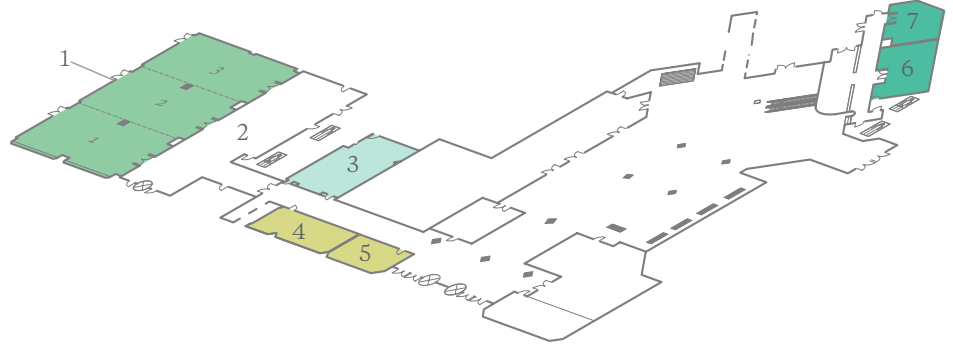

### ROOMS AT A GLANCE

TOTAL GUEST ROOMS	724
TOTAL MEETING ROOMS	32
LARGEST MEETING ROOM CAPACITY	2,000
LARGEST MEETING ROOM SIZE	1,495 m <sup>2</sup> / 15,590 ft <sup>2</sup>

Additional spaces for meetings and events, not displayed here, may also be available. Contact your hotel representative for more information.

This document contains approximate measurements and square footage that are for illustrative purposes only. We cannot guarantee the floor plan accuracy or completeness, therefore encourage you to review the space to make sure it is suitable for your event.

# MEETING SPACE TWENTIETH FLOOR

1 East Pershing Road  
 Kansas City, Missouri 64108  
 T 816.474.4400 F 816.391.4438  
 E westincrowncenterkansascity@starwoodhotels.com  
 westincrowncenterkansascity.com

**THE WESTIN**  
 KANSAS CITY  
 AT CROWN CENTER

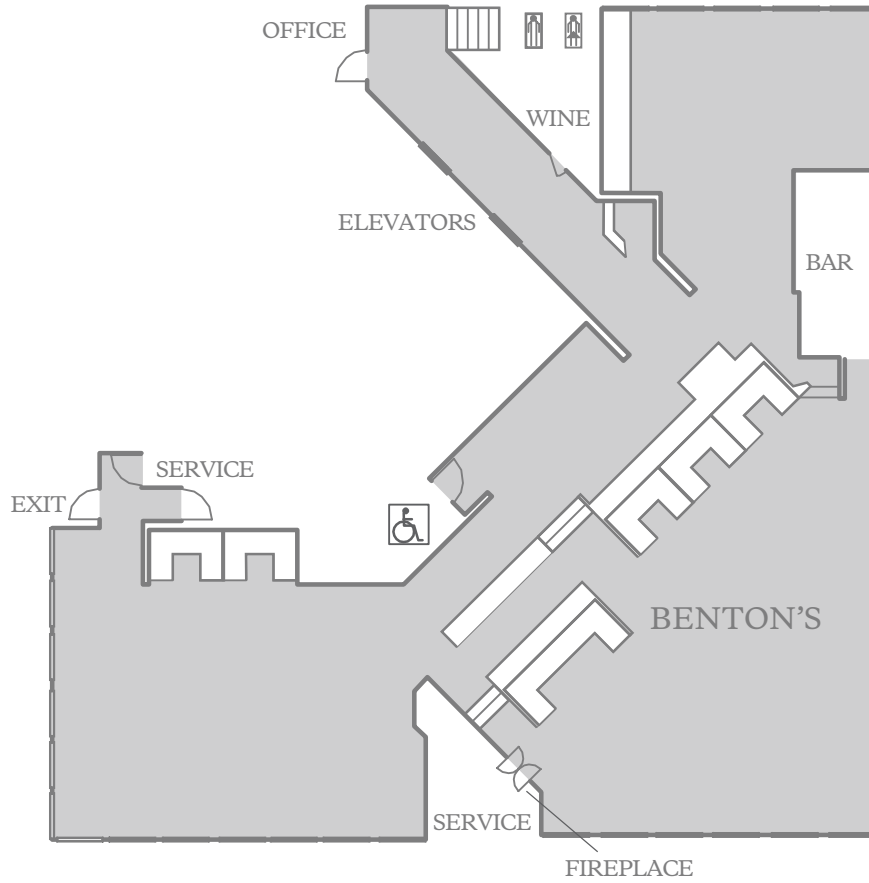

	DIMENSIONS	AREA (SQ. FT.)	MAX CEILING HEIGHT	THEATER	CLASSROOM	BANQUET	CONFERENCE	U-SHAPE	HOLLOW SQ.	RECEPTION
■ BENTON'S	79' X 79'	3,395	10.3'	—	—	—	—	—	—	357

# MEETING SPACE FIFTH FLOOR

1 East Pershing Road  
 Kansas City, Missouri 64108  
 T 816.474.4400 F 816.391.4438  
 E westincrowncenterkansascity@starwoodhotels.com  
 westincrowncenterkansascity.com

**THE WESTIN**  
 KANSAS CITY  
 AT CROWN CENTER

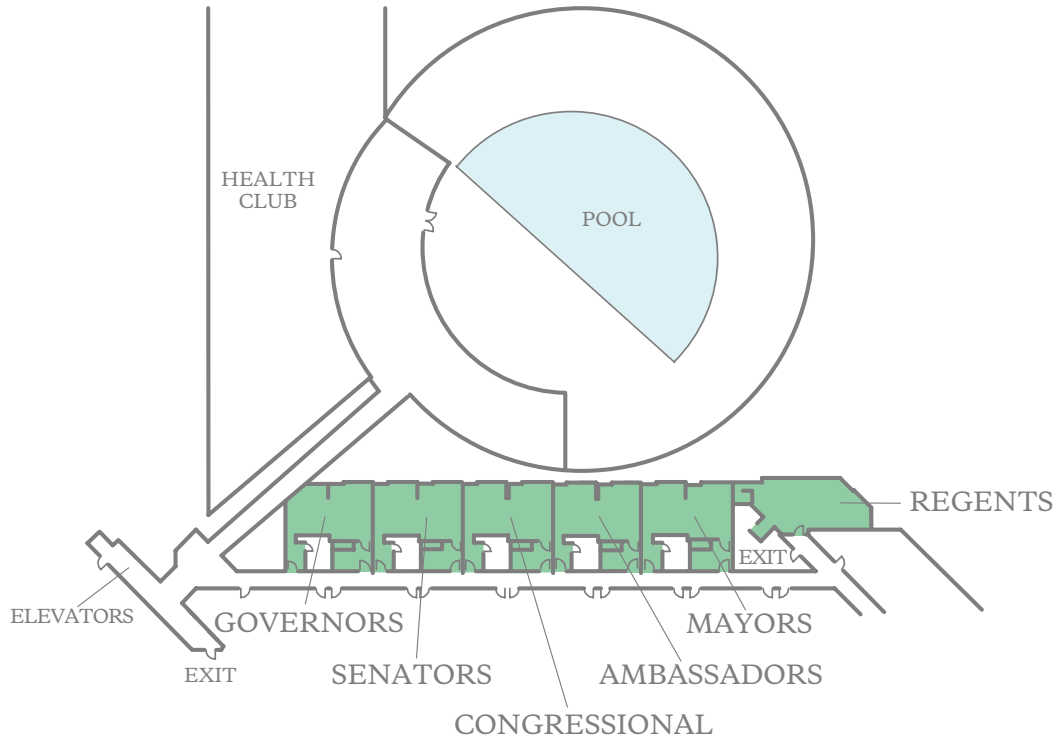

	DIMENSIONS	AREA (SQ. FT.)	MAX CEILING HEIGHT	THEATER	CLASSROOM	BANQUET	CONFERENCE	U-SHAPE	HOLLOW SQ.	RECEPTION
■ AMBASSADORS	28' X 29'	655	7.8'	40	24	20	18	15	—	68
■ CONGRESSIONAL	29' X 29'	674	7.8'	40	24	20	18	15	—	70
■ GOVERNORS	29' X 28'	633	7.9'	40	21	20	18	15	—	66
■ MAYORS	29' X 28'	672	7.9'	40	24	20	18	15	—	70
■ REGENTS	21' X 45'	629	7.9'	40	21	30	18	21	—	66
■ SENATORS	29' X 29'	674	7.8'	40	24	20	18	15	—	70

This document contains approximate measurements and square footage that are for illustrative purposes only. We cannot guarantee the floor plan accuracy or completeness, therefore encourage you to review the space to make sure it is suitable for your event.

# MEETING SPACE BALLROOM LEVEL, PART ONE

1 East Pershing Road  
Kansas City, Missouri 64108  
T 816.474.4400 F 816.391.4438  
E westincrowncenterkansascity@starwoodhotels.com  
westincrowncenterkansascity.com

**THE WESTIN**  
KANSAS CITY  
AT CROWN CENTER

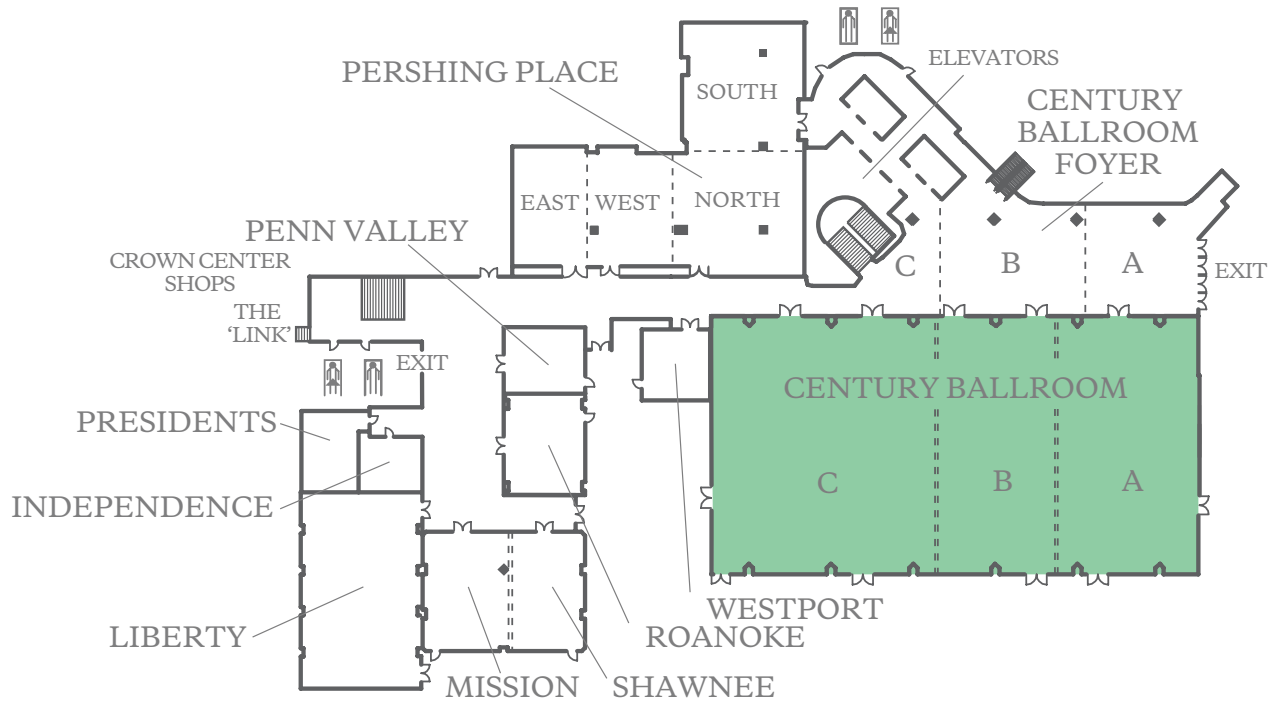

	DIMENSIONS	AREA (SQ. FT.)	MAX CEILING HEIGHT	THEATER	CLASSROOM	BANQUET	CONFERENCE	U-SHAPE	HOLLOW SQ.	RECEPTION
■ CENTURY BALLROOM	91' X 173'	15,590	17'	2,016	957	1,200	—	—	—	1,641
CENTURY BALLROOM FOYER	65' X 200'	5,731	25'	—	—	—	—	—	—	603
CENTURY FOYER A	51' X 54'	1,719	25'	—	—	—	—	—	—	180
CENTURY FOYER A - B	61' X 105'	3,996	25'	—	—	—	—	—	—	420
CENTURY FOYER B	61' X 51'	2,259	25'	—	—	—	—	—	—	237
CENTURY FOYER B - C	65' X 146'	4,011	25'	—	—	—	—	—	—	280
CENTURY FOYER C	51' X 95'	1,743	25'	—	—	—	—	—	—	40
■ CENTURY BALLROOM A	91' X 49'	4,454	17'	540	252	380	—	—	—	468
■ CENTURY BALLROOM A - B	91' X 93'	8,449	17'	1,104	540	640	—	—	—	889
■ CENTURY BALLROOM B	91' X 43'	3,895	17'	416	180	310	—	68	78	400
■ CENTURY BALLROOM B - C	91' X 122'	11,065	17'	1,440	675	800	—	—	—	1,164
■ CENTURY BALLROOM C	91' X 78'	91' X 78'	17'	832	450	560	—	105	132	742

This document contains approximate measurements and square footage that are for illustrative purposes only. We cannot guarantee the floor plan accuracy or completeness, therefore encourage you to review the space to make sure it is suitable for your event.

# MEETING SPACE BALLROOM LEVEL, PART TWO

1 East Pershing Road  
Kansas City, Missouri 64108  
T 816.474.4400 F 816.391.4438  
E westincrowncenterkansascity@starwoodhotels.com  
westincrowncenterkansascity.com

**THE WESTIN**  
KANSAS CITY  
AT CROWN CENTER

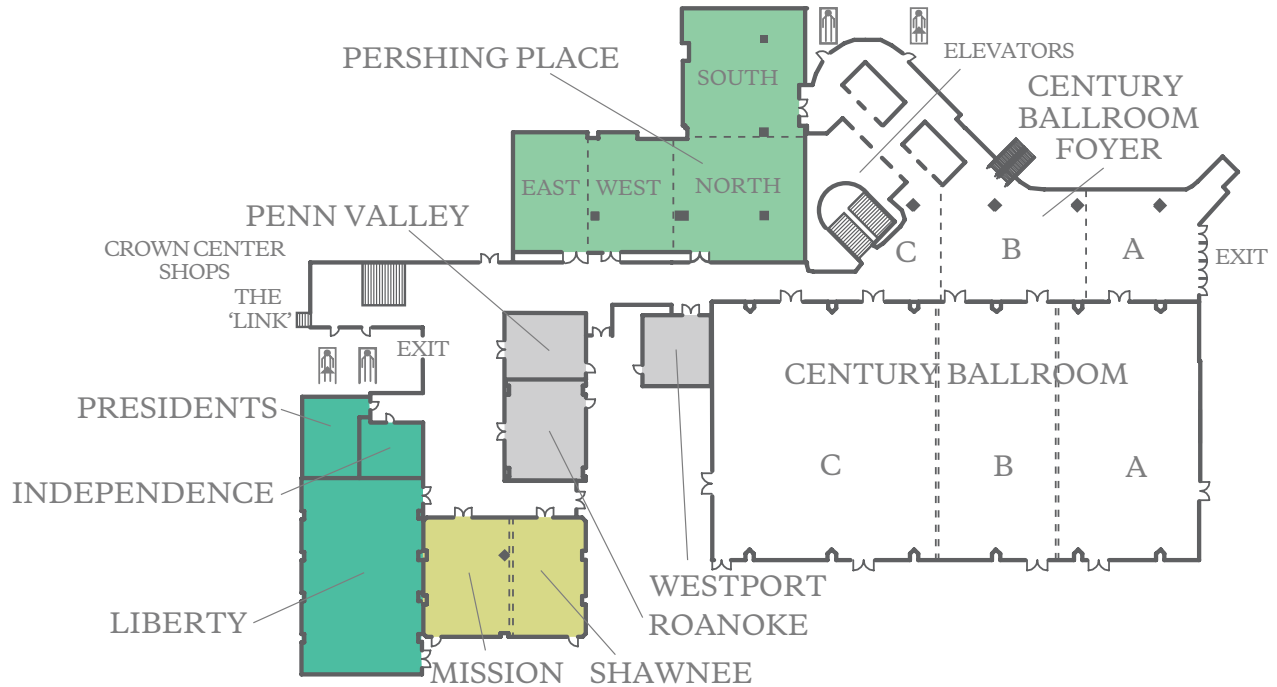

	DIMENSIONS	AREA (SQ. FT.)	MAX CEILING HEIGHT	THEATER	CLASSROOM	BANQUET	CONFERENCE	U-SHAPE	HOLLOW SQ.	RECEPTION
■ INDEPENDENCE	18' X 21'	378	10.6'	30	18	10	12	9	—	35
■ LIBERTY	43' X 69'	2,894	10.9'	324	180	260	60	54	60	304
■ PENN VALLEY	28' X 22'	628	11.9'	60	36	40	18	18	24	66
■ PERSHING PLACE	89' X 103'	6,097	12'	645	297	430	—	—	—	641
■ PERSHING EAST	43' X 27'	1,151	12'	90	54	70	30	36	36	121
■ PERSHING EAST & WEST	44' X 57'	2,355	12'	190	120	150	48	51	54	247
■ PERSHING EAST, WEST & NORTH	45' X 103'	4,295	12'	464	192	250	48	99	96	452
■ PERSHING NORTH	44' X 47'	1,966	12'	110	72	140	36	36	30	206
■ PERSHING NORTH & SOUTH	89' X 47'	3,828	12'	252	156	250	48	81	84	402
■ PERSHING SOUTH	45' X 44'	1,860	12'	110	75	120	36	33	42	195
■ PERSHING WEST	43' X 30'	1,225	12'	100	54	60	30	30	30	128
■ PERSHING WEST & NORTH	45' X 76'	3,172	12'	210	141	220	48	48	54	333
■ PERSHING WEST, NORTH & SOUTH	89' X 76'	5,046	12'	450	228	300	—	—	—	531
■ PRESIDENTS	27' X 24'	557	12.1'	54	24	40	18	15	12	58
■ ROANOKE	29' X 35'	967	11.6'	84	48	60	24	24	36	101
■ SHAWNEE & MISSION	42' X 57'	2,385	11'	262	156	190	48	48	—	251
■ MISSION	42' X 31'	1,275	11'	110	63	100	30	39	42	134
■ SHAWNEE	42' X 26'	1,073	11'	100	63	80	30	36	36	112
■ WESTPORT	26' X 24'	599	9.3'	50	36	40	12	18	18	63

This document contains approximate measurements and square footage that are for illustrative purposes only. We cannot guarantee the floor plan accuracy or completeness, therefore encourage you to review the space to make sure it is suitable for your event.

# MEETING SPACE EXECUTIVE OFFICE LEVEL

1 East Pershing Road  
 Kansas City, Missouri 64108  
 T 816.474.4400 F 816.391.4438  
 E westincrowncenterkansascity@starwoodhotels.com  
 westincrowncenterkansascity.com

**THE WESTIN**  
 KANSAS CITY  
 AT CROWN CENTER

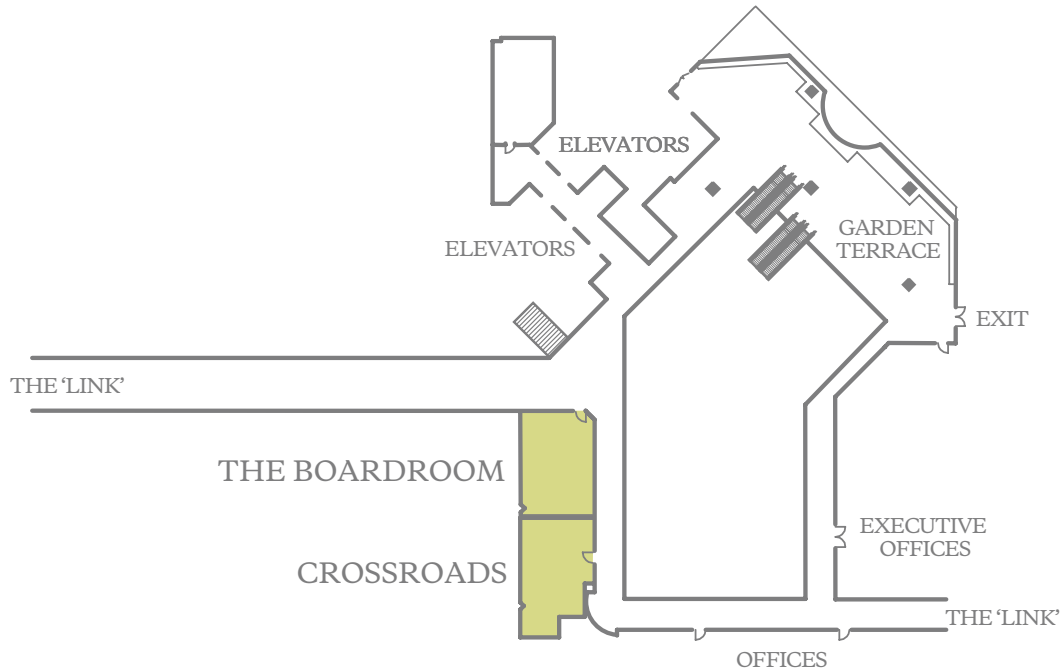

	DIMENSIONS	AREA (SQ. FT.)	MAX CEILING HEIGHT	THEATER	CLASSROOM	BANQUET	CONFERENCE	U-SHAPE	HOLLOW SQ.	RECEPTION
■ THE BOARDROOM	21' X 31'	657	7.4'	—	—	—	12	—	—	—
■ CROSSROADS	22' X 36'	681	7.8'	49	30	20	18	15	18	71
GARDEN TERRACE	62' X 113'	3,657	40'	—	—	200	—	—	—	275



# MEETING SPACE LOBBY LEVEL

1 East Pershing Road  
 Kansas City, Missouri 64108  
 T 816.474.4400 F 816.391.4438  
 E westincrowncenterkansascity@starwoodhotels.com  
 westincrowncenterkansascity.com

**THE WESTIN**  
 KANSAS CITY  
 AT CROWN CENTER

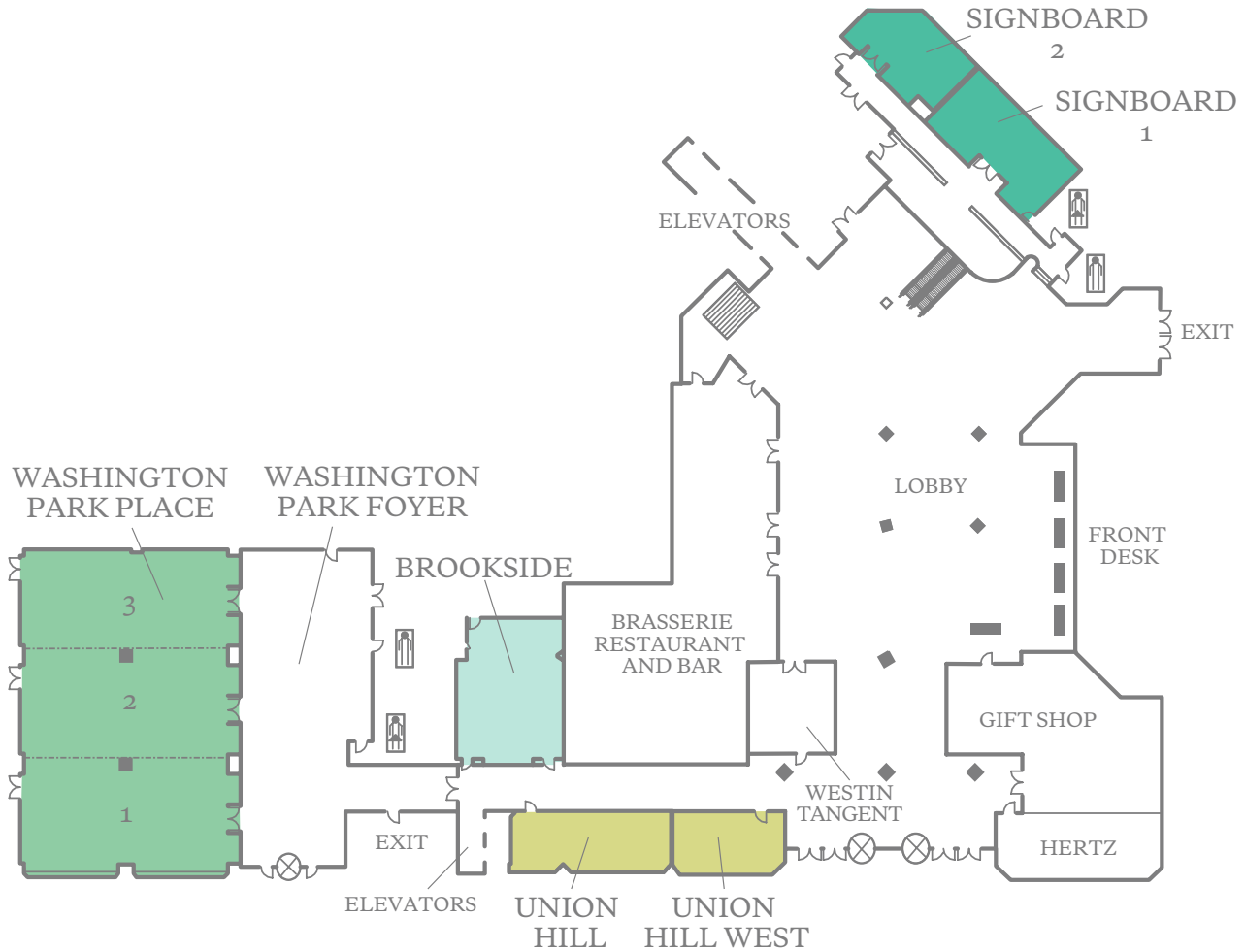

	DIMENSIONS	AREA (SQ. FT.)	MAX CEILING HEIGHT	THEATER	CLASSROOM	BANQUET	CONFERENCE	U-SHAPE	HOLLOW SQ.	RECEPTION
■ BROOKSIDE	39' X 28'	1,035	8.4'	97	69	60	30	30	30	108
■ SIGNBOARD 1	20' X 38'	733	8.9'	48	36	40	30	27	24	77
■ SIGNBOARD 2	20' X 31'	532	7.9'	41	27	20	18	15	12	55
■ UNION HILL	16' X 43'	669	8.4'	35	21	40	18	15	12	70
■ UNION HILL WEST	16' X 30'	467	9.8'	35	21	30	18	15	12	50
WASHINGTON PARK FOYER	84' X 38'	2,650	9.3'	—	—	—	—	—	—	278
■ WASHINGTON PARK PLACE	58' X 87'	4,897	12.1'	480	279	390	—	—	—	515
■ WASHINGTON PARK PLACE 1	58' X 32'	1,765	12.1'	180	105	100	48	48	48	185
■ WASHINGTON PARK PLACE 1 - 2	58' X 61'	3,365	12.1'	338	162	240	—	—	—	354
■ WASHINGTON PARK PLACE 2	58' X 29'	1,644	12.1'	168	81	100	42	48	48	173
■ WASHINGTON PARK PLACE 2 - 3	58' X 55'	3,126	12.1'	308	162	240	—	—	—	329
■ WASHINGTON PARK PLACE 3	58' X 26'	1,457	12.1'	140	81	100	42	42	48	153

This document contains approximate measurements and square footage that are for illustrative purposes only. We cannot guarantee the floor plan accuracy or completeness, therefore encourage you to review the space to make sure it is suitable for your event.



1 East Pershing Road  
Kansas City, Missouri 64108  
T 816.474.4400 F 816.391.4438  
E [westincrowncenterkansascity@starwoodhotels.com](mailto:westincrowncenterkansascity@starwoodhotels.com)  
[westincrowncenterkansascity.com](http://westincrowncenterkansascity.com)

**THE WESTIN**  
KANSAS CITY  
AT CROWN CENTER